



Hollington Old Lane, St. Leonards-On-Sea TN38 9DT

Offers in excess of £230,000



A TWO BEDROOM TERRACE HOME with a COURTYARD GARDEN conveniently located close to popular schools, good transport links and local shops. Spanning two storeys the accommodation here is arranged as a BRIGHT LIVING ROOM which enjoys a front aspect and feature fireplace, whilst the MODERN FITTED KITCHEN and SEPARATE DINING ROOM are both positioned at the rear of the property. The kitchen offers ample storage and worktop space and benefits from access to the courtyard garden. There is also a SEPARATE W/C and HANDY CLOAK CUPBOARD on this floor. The first floor houses TWO DOUBLE BEDROOMS both with BUILT-IN STORAGE. Externally there is a PRIVATE COURTYARD GARDEN creating the PERFECT SPOT TO DINE AL-FRESCO, plus providing outdoor storage. Set in a convenient location, this property would make the perfect FIRST TIME HOME and is not to be missed.

GROUND FLOOR
345 sq.ft. (32.0 sq.m.) approx.

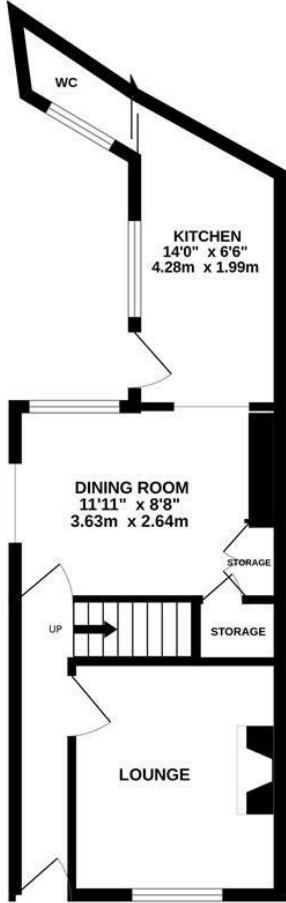

1ST FLOOR
303 sq.ft. (28.2 sq.m.) approx.

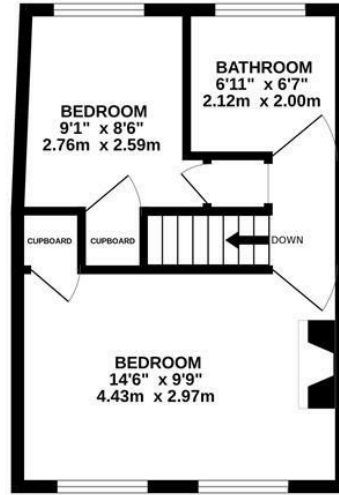

TOTAL FLOOR AREA: 648 sq.ft. (60.2 sq.m.) approx.

Whilst every attempt has been made to ensure the accuracy of the floorplan contained here, measurements of doors, windows, rooms and any other items are approximate and no responsibility is taken for any error, omission or mis-statement. This plan is for illustrative purposes only and should be used as such by any prospective purchaser. The services, systems and appliances shown have not been tested and no guarantee as to their operability or efficiency can be given.
Made with Metropix ©2025

